

## WAC MyTech- Adobe Creative Cloud installation guide 2019

This guide assumes that you have already requested a license via your class teacher. If this has not been done and approved, you will not be able to follow this guide.

1. **Go to the Adobe Creative Cloud site** <https://www.adobe.com/au/creativecloud/desktop-app.html> , and choose 'download'
2. **The website should automatically start the download** of the correct Creative Cloud app for your device. If you have issues with this step, follow the suggestions here: <https://helpx.adobe.com/au/download-install/kb/creative-cloud-desktop-app-download.html>

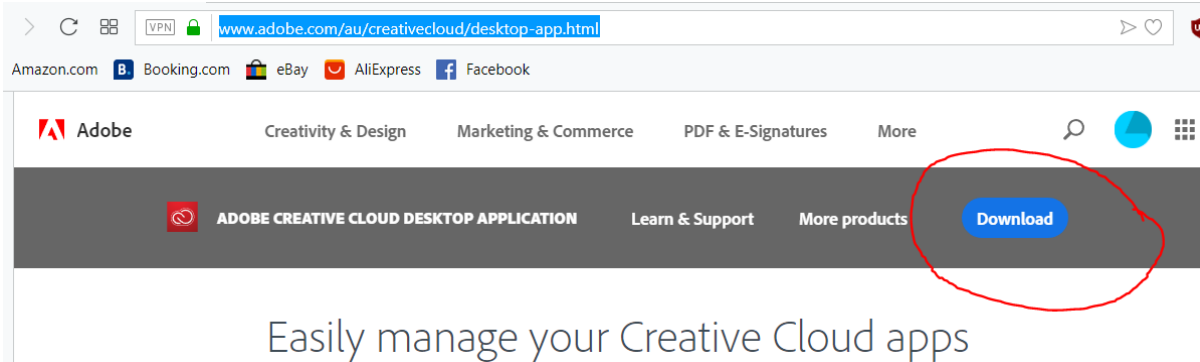

Once the download has finished, **run the Creative Cloud setup file** to install it on your device.



The Creative Cloud desktop app is an easy-to-use tool to manage all of your Adobe apps and services.

Use the installer below to get the latest version of Creative Cloud supported by your OS.

Download didn't start? [Try again](#) | [Need Help](#)

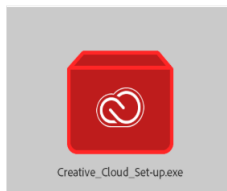

1. Find and open Creative\_Cloud\_Set-Up.exe

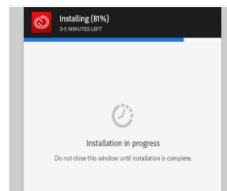

2. Follow the instructions to install the Creative Cloud desktop app.

3. **When prompted, choose 'sign in with an enterprise ID' and enter your College EMAIL ADDRESS.** Then, you'll be redirected to the WAC cloud page

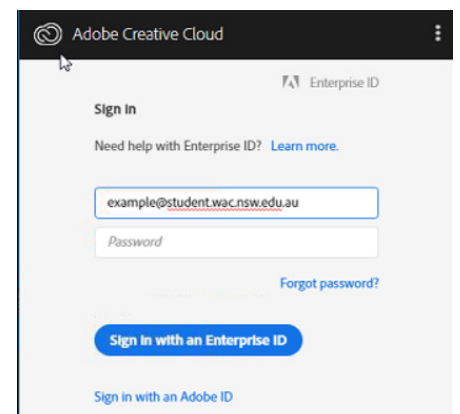
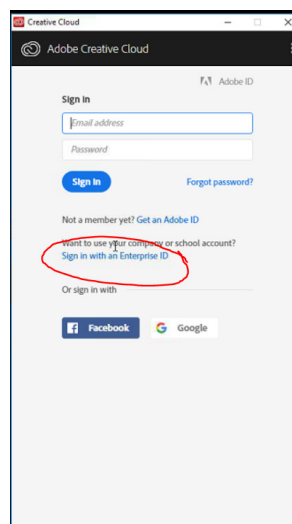
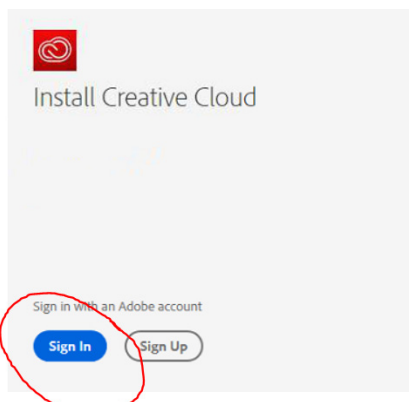

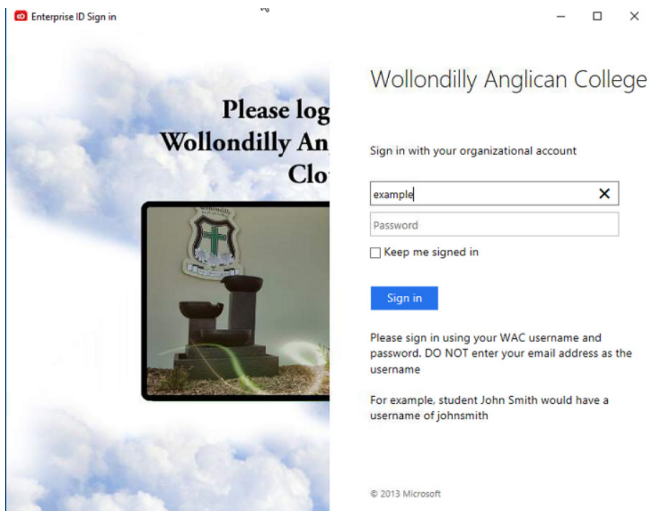

Here, enter your College USERNAME (not email address), and your password

4. You can now start installing the Creative Cloud apps on your device. Just follow the prompts and install the required apps by accessing the 'Apps' tab. There are approximately 40 apps available

